

**Bluewest.de**

info@Bluewest.de

**ADDRESS:**

Neuer Wall 71, c/o WorkRepublic

20354 Hamburg

Germany

**TEL & FAX:** +49 40 99 99 94 42 9



**BLUE WEST**  
GmbH

**SMART HOTEL SOLUTIONS**

**Access Solutions Consulting  
& Sales Company**

For impressive entrances  
For high quality solutions  
For many applications



# SMART HOTEL SOLUTIONS

## COMPANY PROFILE

Blue West is an exceptional German company, specialized in commercial security and access solutions. We develop, produce, assemble and market a complete range of sophisticated top end products, oriented towards openings. We are committed to the highest standards of quality and reliability in offering architectural solutions in the below fields:

1. Door Hardware
2. Lodging Systems
3. Master Key Systems
4. Electronic Access Control & Data
5. Glass Door Accessories
6. Automatic Entrance Systems
7. Gates and Blockers
8. Walls Systems

Blue West is continuously developing their extensive product range and services in conjunction with our reputable international production partners to ensure our customers benefit from the very latest global innovations. Our main objective is offering the ideal entrance solutions or security for all market segments like residential, commercial and institutional complexes.

We additionally customize solutions for customer needs in addition to our standard range of products. Through our architectural consultancy and specification services we support our partners to receive the best applicable product with commercial value in mind.

# BLUE WEST ONE CARD SYSTEM CONFIGURATION

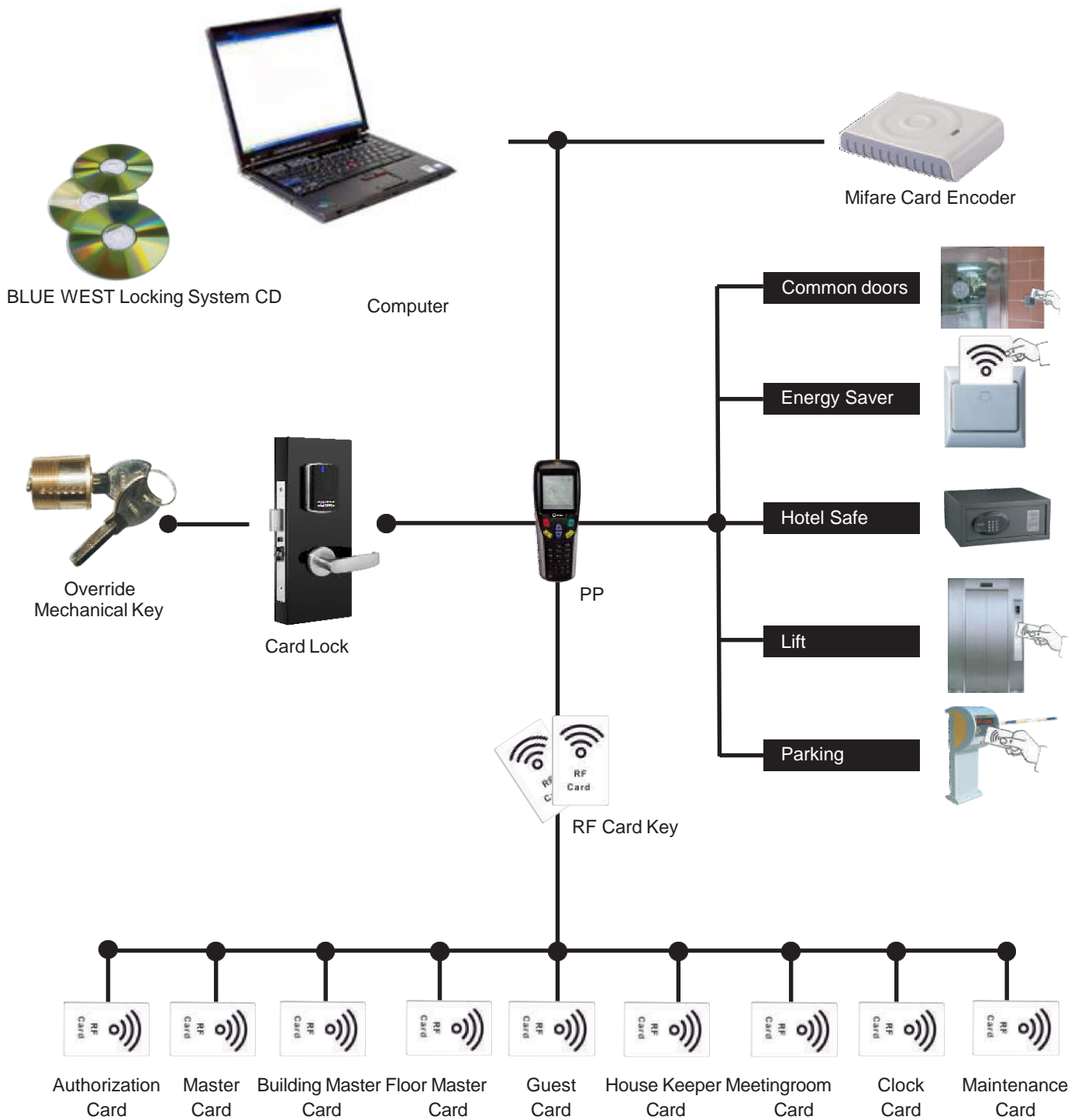

HOTEL LOCKS

BW-S3074

Ultra-thin Design  
**FASHION**



HOTEL LOCKS

BW-S3074



BW-S3074      BW-S3474      BW-S3174      BW-S3574

Technical Parameters	
Model	BW-S3074
Material	Stainless steel, moisture proof, fire rated
Working voltage	DC 6 V or 4 AA alkaline batteries
Power consumption	Static load < 30 µa, dynamic load < 200 ma
Working humidity	20 % -90 % working temperature: -20 °C ~ 60 °C
Keycard option	Mifare one card
Dimension of external panel	L 52 mm x W 52 mm x H 12 mm

Functional Characteristics

- Audit records latest 1680 pcs (max 3260 pcs optional);
- Interface with most of the PMS system, Fidelio / opera registered;
- CE & FCC certified;
- Standard finish stainless steel / optional color finish- black; gold and bronze;
- ANSI standard mortise;
- Inside dead bolt, inside handle retracts latches and deadbolt;
- Mifare 1 card, compatible with mifare energysaver;
- Lost guest card suspension simply by issuing a new guest card with suspending function;
- Multiple operators with different card issuing authorization;
- Low battery voltage warning.(Lower then 4.8 v);
- Self error detecting with "beep" ;
- Passage model function available;
- Can be integrated with 16 public areas such as lift / parking / swimming pool / sauna room / tennis court / gym and etc.

304 Stainless Steel Material

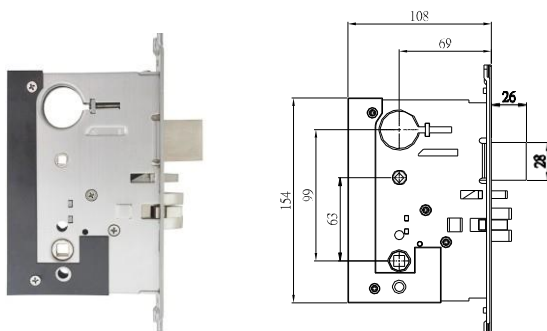

Product appearance sketch

Unit: mm

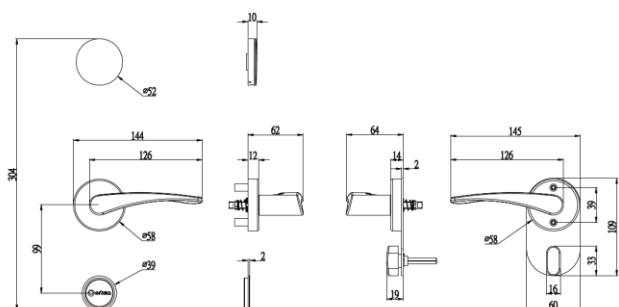

HOTEL LOCKS

BW-S3479



## Split Design

Aesthetic Design With  
Hidden Cylinder

HOTEL LOCKS

BW-S3479

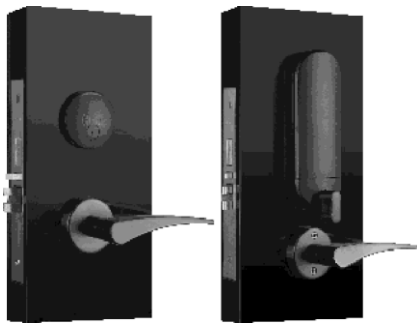

Technical Parameters	
Model	BW-S3479
Material	Stainless steel, moisture proof, fire rated
Working voltage	DC 6 V or 4 AA alkaline batteries
Power consumption	Static load < 30 µa, dynamic load < 200 ma
Working humidity	20 % -90 % working temperature: -20 °C ~ 60 °C
Keycard option	Mifare one card
Dimension of external panel	L 60 mm x W 60 mm x H 12 mm

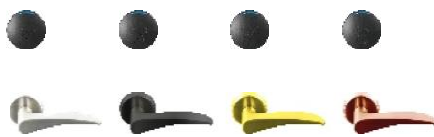

BW-S3079      BW-S3479      BW-S3179      BW-S3579

Functional Characteristics

- Audit records latest 1680 pcs (max 3260 pcs optional);
- Interface with most of the PMS system, Fidelio / opera registered;
- CE & FCC certified;
- Standard finish stainless steel / optional color finish- black; gold and bronze;
- ANSI standard mortise;
- Inside dead bolt, inside handle retracts latches and deadbolt;
- Mifare 1 card, compatible with mifare energysaver;
- Lost guest card suspension simply by issuing a new guest card with suspending function;
- Multiple operators with different card issuing authorization;
- Low battery voltage warning.(Lower then 4.8 v);
- Self error detecting with "beep" ;
- Passage model function available;
- Can be integrated with 16 public areas such as lift / parking / swimming pool / sauna room / tennis court / gym and etc.

304 Stainless Steel Material

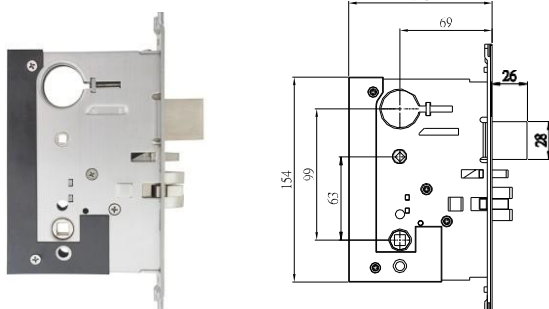

Product appearance sketch

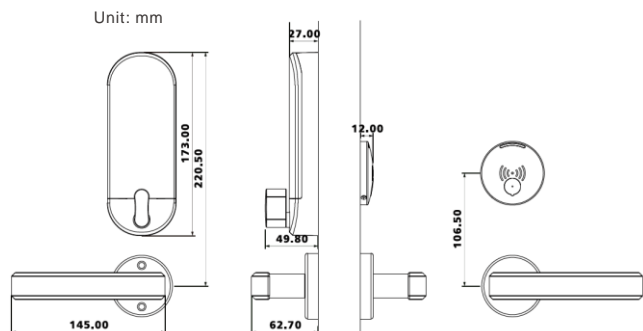



HOTEL LOCKS

BW-S3078



HOTEL LOCKS

BW-S3078



BW-S3078      BW-S3478      BW-S3178      BW-S3578

Technical Parameters	
Model	BW-S3078
Material	Stainless steel, moisture proof, fire rated
Working voltage	DC 6 V or 4 AA alkaline batteries
Power consumption	Static load < 30 µa, dynamic load < 200 ma
Working humidity	20 % -90 % working temperature: -20 °C ~ 60 °C
Keycard option	Mifare one card
Dimension of external panel	L 125 mm x W 61 mm x H 22 mm

Functional Characteristics

- Audit records latest 1680 pcs (max 3260 pcs optional);
- Interface with most of the PMS system, Fidelio / opera registered;
- CE & FCC certified;
- Standard finish stainless steel / optional color finish- black; gold and bronze;
- ANSI standard mortise;
- Inside dead bolt, inside handle retracts latches and deadbolt;
- Mifare 1 card, compatible with mifare energysaver;
- Lost guest card suspension simply by issuing a new guest card with suspending function;
- Multiple operators with different card issuing authorization;
- Low battery voltage warning.(Lower then 4.8 v);
- Self error detecting with "beep" ;
- Passage model function available;
- Can be integrated with 16 public areas such as lift / parking / swimming pool / sauna room / tennis court / gym and etc.

304 Stainless Steel Material

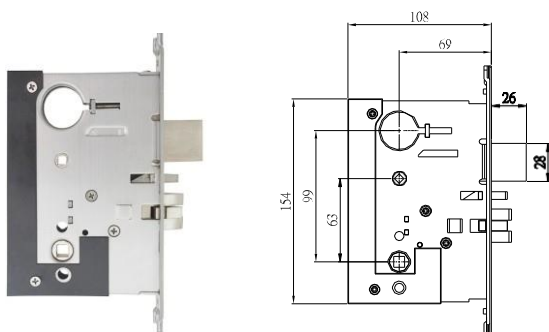

Product appearance sketch

Unit: mm

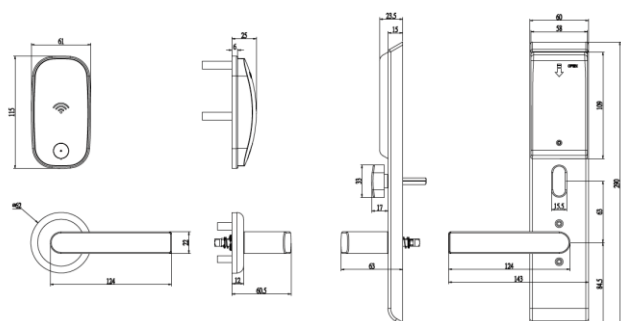

HOTEL LOCKS

BW-S3072H



HOTEL LOCKS

BW-S3072H



BW-S3072H      BW-S3472H      BW-S3172H      BW-S3572H

Technical Parameters	
Model	BW-S3072H
Material	Stainless steel, moisture proof, fire rated
Working voltage	DC 6 V or 4 AA alkaline batteries
Power consumption	Static load < 30 µa, dynamic load < 200 ma
Working humidity	20 % - 90 % working temperature: -20 °C ~ 60 °C
Keycard option	Mifare one card
Dimension of external panel	L 95 mm x W 62 mm x H 26.8 mm

Functional Characteristics

- Audit records latest 1680 pcs (max 3260 pcs optional);
- Interface with most of the PMS system, Fidelio / opera registered;
- CE & FCC certified;
- Standard finish stainless steel / optional color finish- black; gold and bronze;
- ANSI standard mortise;
- Inside dead bolt, inside handle retracts latches and deadbolt;
- Mifare 1 card, compatible with mifare energysaver;
- Lost guest card suspension simply by issuing a new guest card with suspending function;
- Multiple operators with different card issuing authorization;
- Low battery voltage warning.(Lower then 4.8 v);
- Self error detecting with "beep" ;
- Passage model function available;
- Can be integrated with 16 public areas such as lift / parking / swimming pool / sauna room / tennis court / gym and etc.

304 Stainless Steel Material

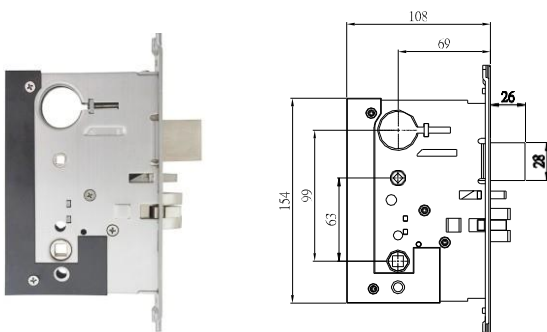

Product appearance sketch

Unit: mm

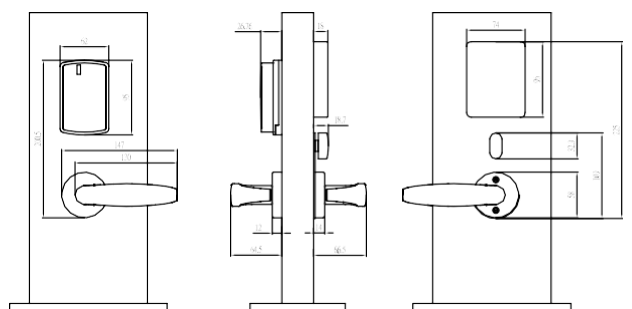

HOTEL LOCKS

BW-3063-P



Technical Parameters	
Model	BW-3063-P
Material	Stainless steel, moisture proof, fire rated
Working voltage	DC 6 V or 4 AA alkaline batteries
Power consumption	Static load < 30 $\mu$ a, dynamic load < 200 ma
Working humidity	20 % -90 % working temperature: -20 $^{\circ}$ C ~ 60 $^{\circ}$ C
Keycard option	Mifare one card
Dimension of external panel	L 94 mm x W 36 mm xH 20 mm

Functional Characteristics

- Audit records latest 1680 pcs (max 3260 pcs optional);
- Interface with most of the PMS system, Fidelio / opera registered;
- CE & FCC certified;
- Standard finish stainless steel / optional color finish- black; gold and bronze;
- ANSI standard mortise;
- Inside dead bolt, inside handle retracts latches and deadbolt;
- Mifare 1 card, compatible with mifare energysaver;
- Lost guest card suspension simply by issuing a new guest card with suspending function;
- Multiple operators with different card issuing authorization;
- Low battery voltage warning. (Lower than 4.8 v);
- Self error detecting with "beep" ;
- Passage model function available;
- Can be integrated with 16 public areas such as lift / parking / swimming pool / sauna room / tennis court / gym and etc.



304 Stainless Steel Material

Unit: mm

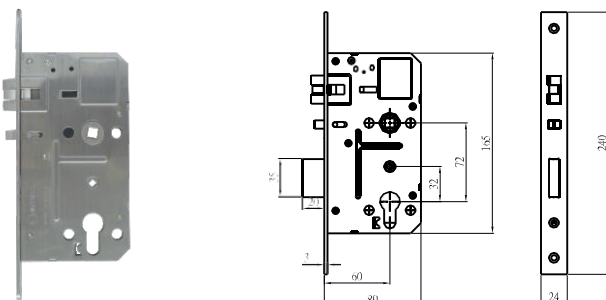

Product appearance sketch

Unit: mm

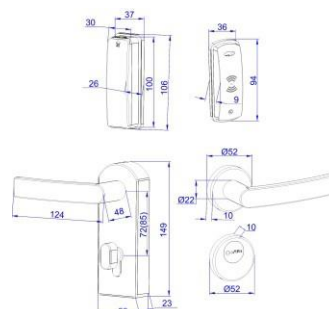

HOTEL LOCKS

BW-S4032



Technical Parameters	
Model	BW-S4032
Material	304 stainless steel, moisture proof, fire rated
Working voltage	DC 6 V or 4 AA alkaline batteries
Power consumption	Static load < 30 µa, dynamic load < 200 ma
Working humidity	20 % -90 % working temperature: -20 °C ~ 60 °C
Keycard option	Mifare one card
Dimension of external panel	L 100 mm x W 65 mm x H 15 mm

Functional Characteristics

- Audit records latest 1680 pcs (max 3260 pcs optional);
- Interface with most of the PMS system, Fidelio / opera registered;
- CE & FCC certified;
- Standard finish stainless steel / optional color finish- black; gold and bronze;
- ANSI standard mortise;
- Inside dead bolt, inside handle retracts latches and deadbolt;
- Mifare 1 card, compatible with mifare energysaver;
- Lost guest card suspension simply by issuing a new guest card with suspending function;
- Multiple operators with different card issuing authorization;
- Low battery voltage warning. (Lower than 4.8 v);
- Self error detecting with "beep" ;
- Passage model function available;
- Can be integrated with 16 public areas such as lift / parking / swimming pool / sauna room / tennis court / gym and etc.



BW-S4032    BW-S4432    BW-S4132    BW-S4532

304 Stainless Steel Material

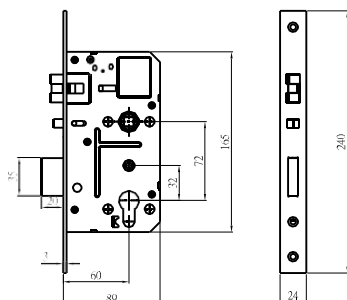

Unit: mm

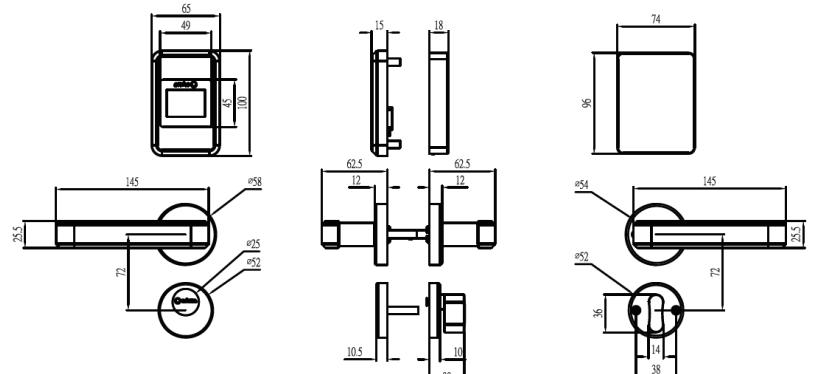

**HOTEL LOCKS**

**BW-E4031**

**LCD HOTEL LOCK**



HOTEL LOCKS

BW-E4031



Technical Parameters	
Model	BW-E4031
Material	Stainless steel, moisture proof, fire rated
Working voltage	DC 6 V or 4 AA alkaline batteries
Power consumption	Static load < 30 µa, dynamic load < 200 ma
Working humidity	20 % -90 % working temperature: -20 °C ~ 60 °C
Keycard option	Mifare one card
Dimension of external panel	L 280 mm x W 75 mm x H 22 mm

Functional Characteristics

- Audit records latest 1680 pcs (max 3260 pcs optional);
- Interface with most of the PMS system, Fidelio / opera registered;
- CE & FCC certified;
- Standard finish stainless steel / optional color finish- black; gold and bronze;
- ANSI standard mortise;
- Inside dead bolt, inside handle retracts latches and deadbolt;
- Mifare 1 card, compatible with mifare energysaver;
- Lost guest card suspension simply by issuing a new guest card with suspending function;
- Multiple operators with different card issuing authorization;
- Low battery voltage warning.(Lower then 4.8 v);
- Self error detecting with "beep" ;
- Passage model function available;
- Can be integrated with 16 public areas such as lift / parking / swimming pool / sauna room / tennis court / gym and etc.



BW-E4031      BW-E4431      BW-E4131      BW-E4531

304 Stainless Steel Material

Unit: mm

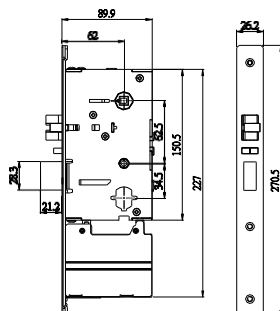

Product appearance sketch

Unit: mm

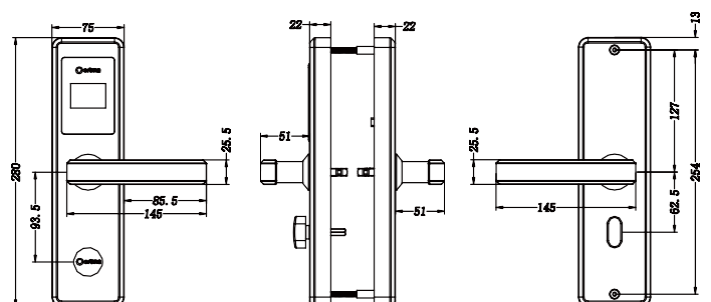



## HOTEL LOCKS

BW-E3041

# WATERPROOF DESIGN

Complete 304 stainless steel material  
Sealed electronics

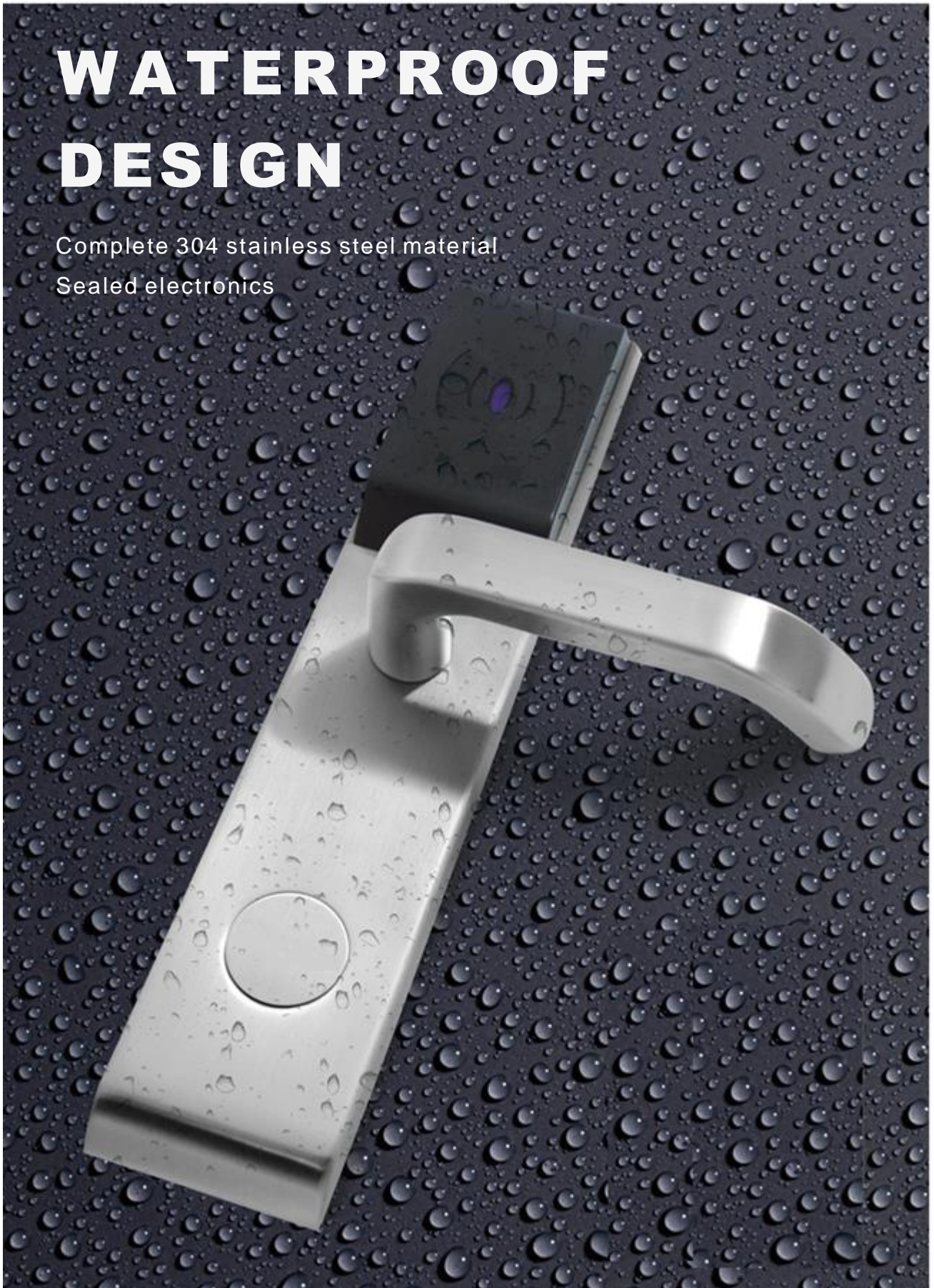

HOTEL LOCKS

BW-E3041



BW-E3041      BW-E3441      BW-E3141      BW-E3541

Technical Parameters	
Model	BW-E3041
Material	Stainless steel, moisture proof, fire rated
Working voltage	DC 6 V or 4 AA alkaline batteries
Power consumption	Static load < 30 µa, dynamic load < 200 ma
Working humidity	20 % -90 % working temperature: -20 °C ~ 60 °C
Keycard option	Mifare one card
Dimension of external panel	L 290 mm x W 60 mm xH 15 mm

Functional Characteristics

- Audit records latest 1680 pcs (max 3260 pcs optional);
- Interface with most of the PMS system, Fidelio / opera registered;
- CE & FCC certified;
- Standard finish stainless steel / optional color finish- black; gold and bronze;
- ANSI standard mortise;
- Inside dead bolt, inside handle retracts latches and deadbolt;
- Mifare 1 card, compatible with mifare energysaver;
- Lost guest card suspension simply by issuing a new guest card with suspending function;
- Multiple operators with different card issuing authorization;
- Low battery voltage warning.(Lower then 4.8 v);
- Self error detecting with "beep" ;
- Passage model function available;
- Can be integrated with 16 public areas such as lift / parking / swimming pool / sauna room / tennis court / gym and etc.

Product appearance sketch

Unit: mm

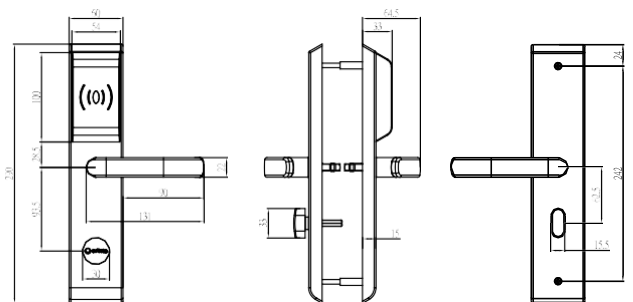

304 Stainless Steel Material

Unit: mm

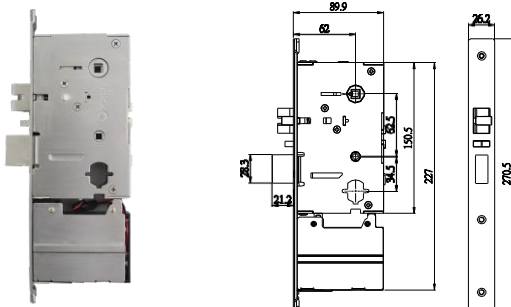

HOTEL LOCKS

BW-3092



Technical Parameters	
Model	BW-3092
Material	Stainless steel, moisture proof, fire rated
Working voltage	DC 6 V or 4 AA alkaline batteries
Power consumption	Static load < 30 $\mu$ a, dynamic load < 200 ma
Working humidity	20 % -90 % working temperature: -20 $^{\circ}$ C~ 60 $^{\circ}$ C
Keycard option	Mifare one card
Dimension of external panel	L 295 mm x W 76 mm x H 17 mm

Functional Characteristics

- Audit records latest 1680 pcs (max 3260 pcs optional);
- Interface with most of the PMS system, Fidelio / opera registered;
- CE & FCC certified;
- Standard finish stainless steel / optional color finish- black; gold and bronze;
- ANSI standard mortise;
- Inside dead bolt, inside handle retracts latches and deadbolt;
- Mifare 1 card, compatible with mifare energy saver;
- Lost guest card suspension simply by issuing a new guest card with suspending function;
- Multiple operators with different card issuing authorization;
- Low battery voltage warning. (Lower than 4.8 v);
- Self error detecting with "beep" ;
- Passage model function available;
- Can be integrated with 16 public areas such as lift / parking / swimming pool / sauna room / tennis court / gym and etc.

304 Stainless Steel Material

Unit: mm

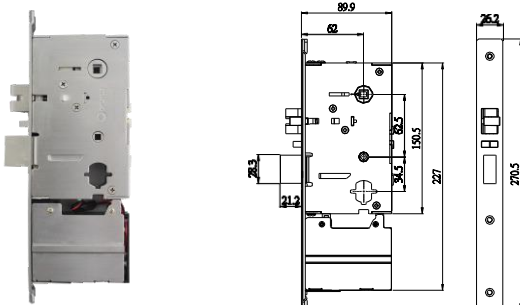

Product appearance sketch

Unit: mm

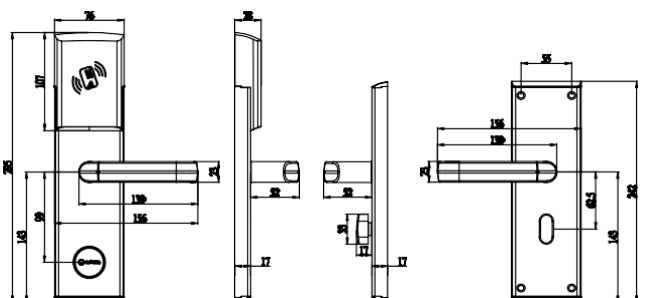

HOTEL LOCKS

BW-E3064P



Technical Parameters	
Model	BW-E3064P
Material	304 stainless steel, moisture proof, fire rated
Working voltage	DC 6 V or 4 AA alkaline batteries
Power consumption	Static load < 30 µa, dynamic load < 200 ma
Working humidity	20 % -90 % working temperature: -20 °C ~ 60 °C
Keycard option	Mifare one card
Dimension of external panel	L 280 mm x W 40 mm x H 13 mm



Functional Characteristics

- Audit records latest 1680 pcs (max 3260 pcs optional);
- Interface with most of the PMS system, Fidelio / opera registered;
- CE & FCC certified;
- Standard finish stainless steel / optional color finish- black; gold and bronze;
- European standard mortise;
- Inside dead bolt, inside handle retracts latches and deadbolt;
- Mifare 1 card, compatible with mifare energysaver;
- Lost guest card suspension simply by issuing a new guest card with suspending function;
- Multiple operators with different card issuing authorization;
- Low battery voltage warning.(Lower then 4.8 v);
- Self error detecting with "beep" ;
- Passage model function available;
- Can be integrated with 16 public areas such as lift / parking / swimming pool / sauna room / tennis court / gym and etc.



BW-E3064P    BW-E3464P    BW-E3164P    BW-E3564P

304 Stainless Steel Material

Unit: mm

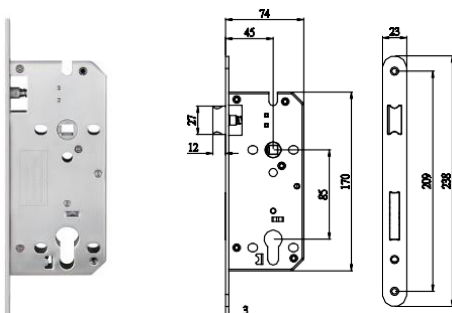

# BLUETOOTH HOTEL LOCK

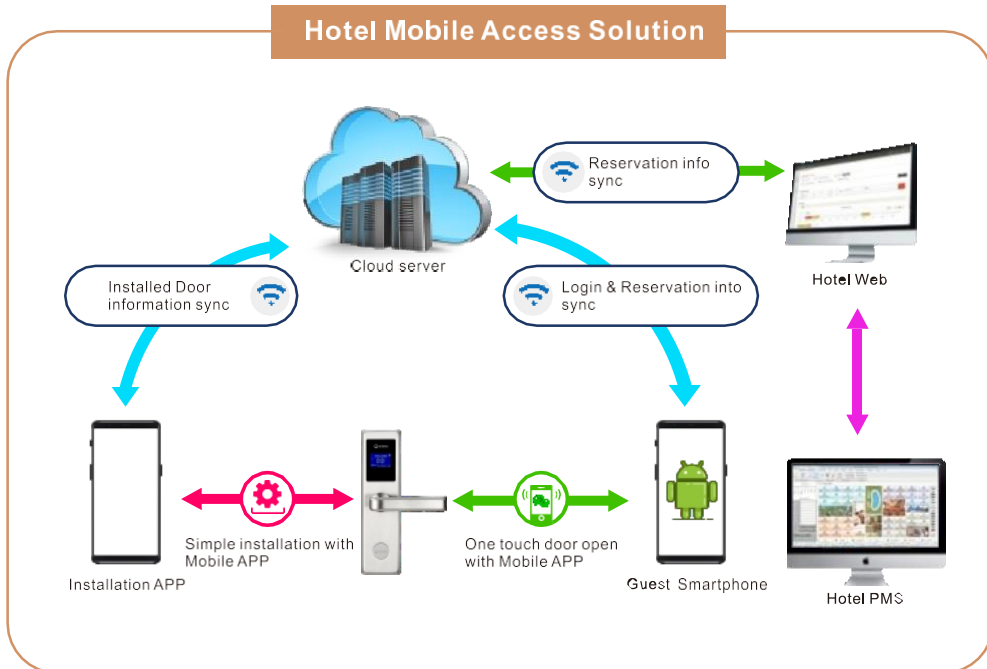

## BLUE WEST HOTEL ROOM SAVES



BW-2045MB: H 200 \* L 450: D 400 mm

BW-2043MB: H 200 \* L 430: D 370 mm

BW-2040MB: H 200 \* L 400: D 300 mm

BW-2031MB: H 200 \* L 310: D 200 mm



BW-2045ME: H 200 \* L 450: D 400 mm

BW-2043ME: H 200 \* L 430: D 370 mm

BW-2040ME: H 200 \* L 400: D 200 mm

BW-2031ME: H 200 \* L 310: D 200 mm

### CONSTRUCTION

3 mm Cold-Rolled Steel Door  
Two 3/4 inch (19 mm) Diameter Steel Locking Bolts  
Scratch-Resistant Powder Coat Finish

### FEATURES

Enhanced LED Display  
Audio/Visual Operating Signals  
Opening: Two sets of password operation— 4-digit guest password/ 6-digit master password/ 6-CEU password(Optional) and override key  
Event audit trail(Optional)  
Easy Access Battery Panel  
Emergency Battery Jumper Box  
Secure Pedestal Mounting  
Mechanical Fail-Safe Override Key  
Tamper-Proof Installation Hardware  
Inner carpet  
Spring loaded door  
Fixing holes at bottom and back with screws  
Auto secure mode (3 times wrong input of code gets frozen for 15mins)

### OTHERS

Warranty: 1 year  
Batteries: 4AA  
Low Battery warning  
Batteries included

### CONSTRUCTION

3 mm Cold-Rolled Steel Door  
Two 3/4 inch (19 mm) Diameter Steel Locking Bolts  
Scratch-Resistant Powder Coat Finish

### FEATURES

Enhanced LED Display  
Audio/Visual Operating Signals  
Opening: Two sets of password operation— 4-digit guest password/ 6-digit master password and override key  
Easy Access Battery Panel  
Emergency Battery Jumper Box  
Secure Pedestal Mounting  
Mechanical Fail-Safe Override Key  
Tamper-Proof Installation Hardware  
Inner carpet  
Spring loaded door  
Fixing holes at bottom and back with screws  
Auto secure mode (3 times wrong input of code gets frozen for 15mins)

### OTHERS

Warranty: 1 year  
Batteries: 4AA  
Low Battery warning  
Batteries included

## BLUE WEST HOTEL ROOM SAVES



BW-2043 MD  
SIZES: H 200 \* L 430: D 4370 mm



BW-4135 MG

## BLUE WEST HOTEL MINIBARS



BW-30X



BW-30D



BW-40BB



BW-40GB



BW-60BA



BW-60GA

**Support 30 liter to 60 liter with black door and glass door**

Cooling by ammonia;

No moving part, no compressor, no fan, no vibration, no noise (0 db), Free maintenance & long life.

MODEL	BW-30	BW-40	BW-60
Cooling Method	Absorption	Absorption	Absorption
Storage Temperature (°C)	0-12	0-12	0-12
Input Power (W)	65	65	85
Energy Consumption (kwh / 24 h)	0.9	0.9	1.2
Validity Capacity (L)	30	40	60
Voltage (V)	AC 220 / 110	AC 220 / 110	AC 220 / 110
Type of controller	Digital	Digital	Digital
Type of door seal	Removable	Removable	Removable
Net/Gross Weight (KG)	16.5 / 18.5	18.5 / 20.5	21 / 21.5
Shape size (W * D * H)	400 * 420 * 517	400 * 470 * 517	482 * 480 * 521
Packing size (W * D * H)	460 * 450 * 560	460 * 500 * 560	530 * 510 * 600





Application system diagram

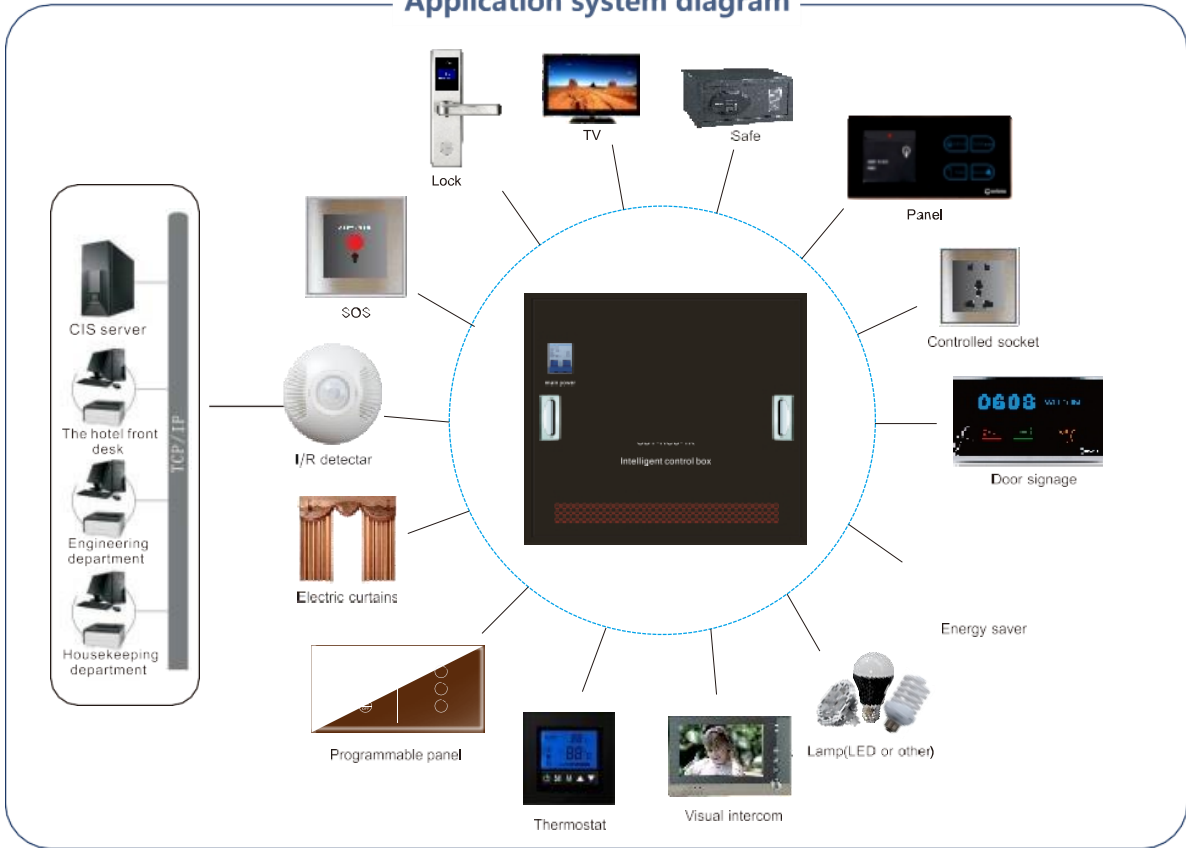

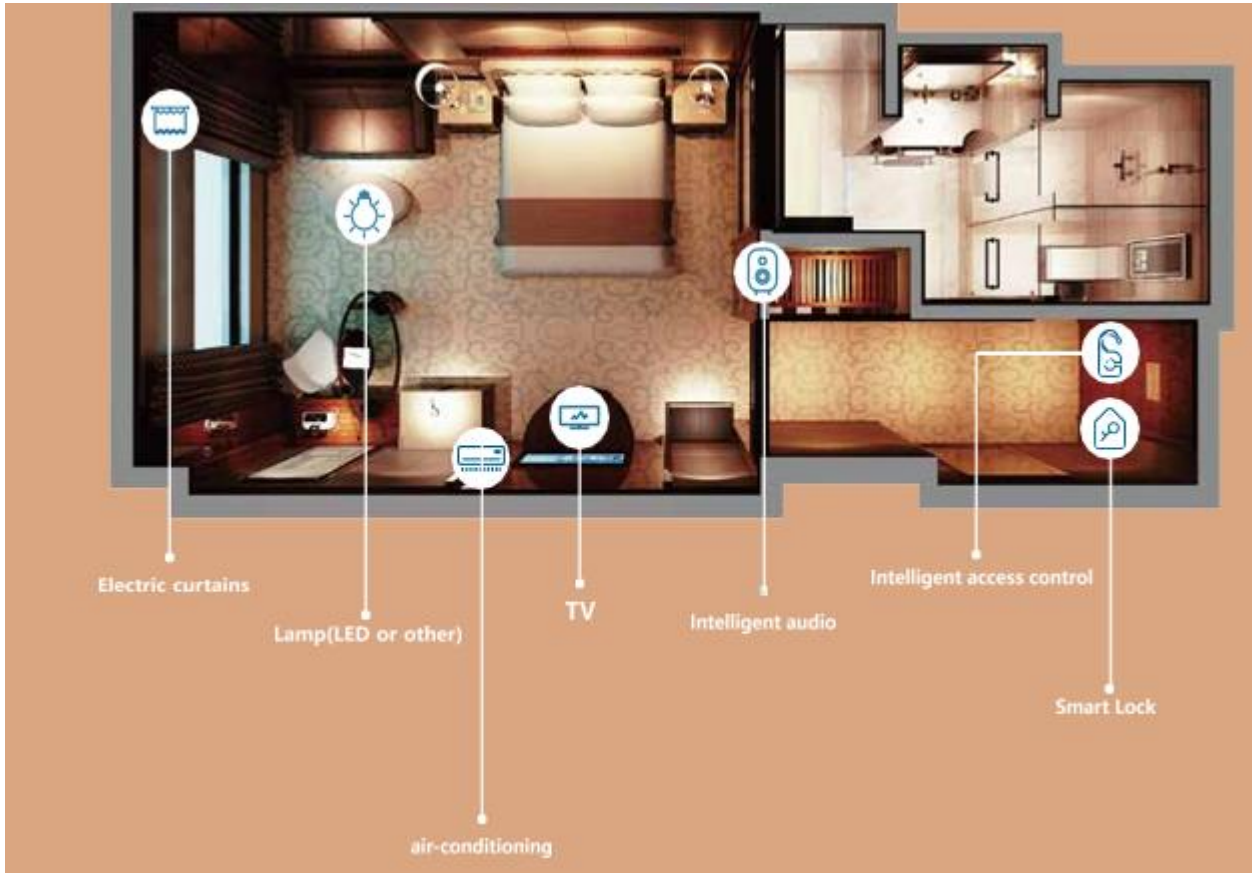

Network diagram

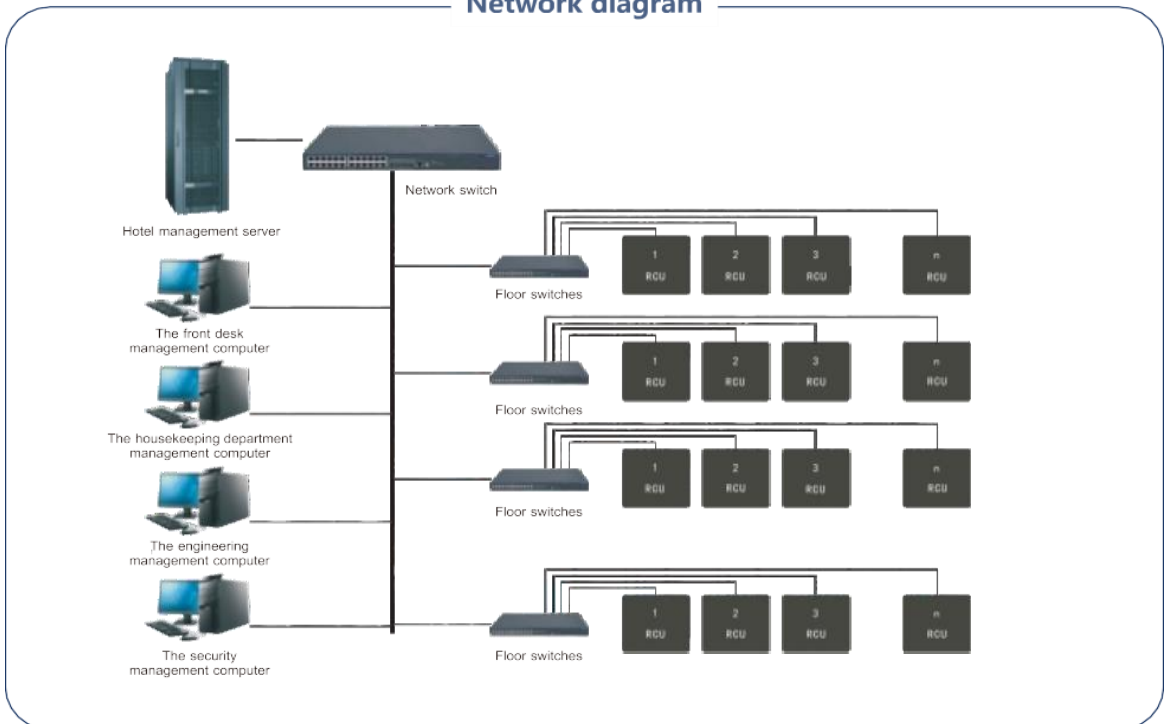

## ENERGY SAVING SWITCHES

### Room Only Type

### Frequency Type

### 3 Phase Type

Size: 86 mm * 86 mm
A / C 220 V
Mifare 13.56 MHz
Only specific room card can get power
Name card can not get power

Size: 86 mm * 86 mm
A / C 220 V
Mifare 13.56 MHz
Any mifare card can get power
Name card can not get power

Size: 86 mm * 86 mm
D / C 12 V, 120 A, 3 Phase output
Guest card get all power
Staff card get limited power
Name card can not get power



BW-ESS-20



BW-ESS-40



BW-ESS-70

## Energy saver with don't disturb and make up room

Size: 86 mm * 172 mm
A / C 220 V or DC 12 V
Mifare card / room card / 3 phase
Name card can not get power



BW-ESTP-01

# DOOR SIGNAGES



BW-DS-358HR



BW-DS-202HS



BW-DS-258HR



BW-DS-200UP



BW-DS-201HP



BW-DS-201HG



BW-DS-200HS



BW-DS-100S

# BEDSIDE CONSOLE & TOUCH SCREEN PANELS



BW-TSS-02



BW-TSS-42S



BW-BC-13B



BW-BC-20B



BW-BC-18G



BW-BC-10S

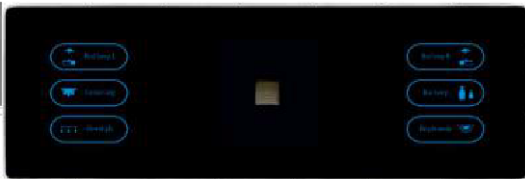

BW-TSP-01S



BW-TSP-02S

## WIRELESS PORTABLE PROGRAMMER



### TECHNICAL PARAMETERS

Dimension of external panel	L 182 mm * W 68 mm * H 40 mm
Material	Black Plastic
Support type	Mifare Smart Door Locks
Working frequency	13.56 MHz
Reading distance	3 ~ 10 cm
Ambient temperature	-50 °C ~ 120 °C

### FUNCTIONAL CHARACTERISTICS

- Wireless;
- Program locks;
- Update clock;
- Read & download openings;
- Open locks as master key.

## LIFT READER & CONTROLLER

### Lift reader

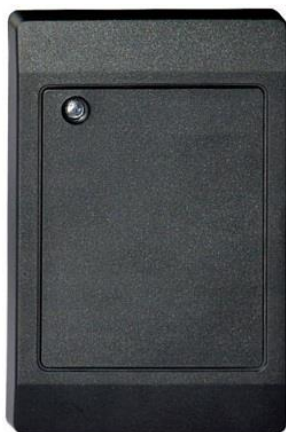

BW-MFR-01



BW-MFR-02



BW-MFR-03



BW-MFR-04

### Lift controller

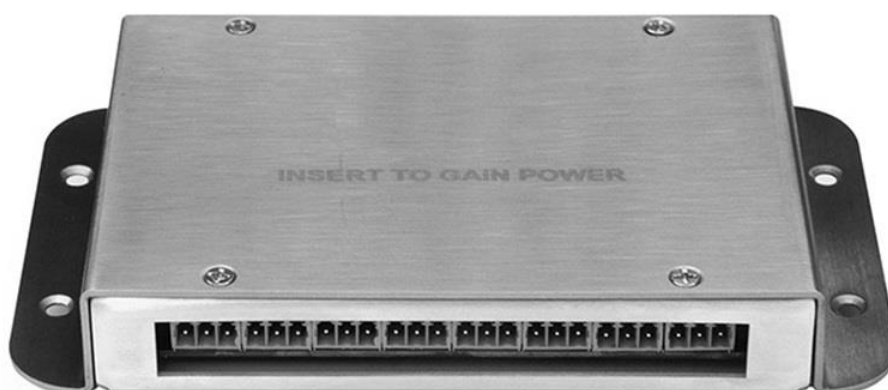

BW-MFC-03

### FEATURES

- Show guest card, go directly to the guest floor;
- Show staff card, activate all buttons;
- No card can not access;
- Public floor;
- Emergency or damage, recover lift default function.

Thank you for your attention